

Marine Construction Works/Land Reclamation/Beach Replenishment in the Territorial Sea and Controlled Waters Adjacent to Northern Ireland

Marine Licensing

Important: before completing this form, please read these notes carefully.

The following numbered paragraphs correspond to the questions on the application form and are intended to assist applicants in completing the form. These explanatory notes are specific to this application and so applicants are advised to read these in conjunction with the General Marine Licensing Guidance document. However it may be that these notes do not fully cover all the questions that you may have. If further clarification is needed please telephone us on

028 90569247 or email

MarineLicensingTeam@daera-ni.gov.uk

For fees categories please see Marine Licensing Fees Addendum

For further Guidance please refer to Marine Licensing Guidance for Applicants

EXPLANATORY NOTES

2. Applicant

The person, company or organisation making the application. (The licensee(s) may be any of the following, the contractor actually carrying out the construction work, the applicant and possibly other bodies involved).

3. Agent

Any person, company or organisation acting on behalf of the applicant. They may be acting under contract (or other agreement) on behalf of any party listed in the answer to question 2, and have responsibility for the control; management or physical deposit of materials anywhere below the tidal limit of the mean high water springs (MHWS). (e.g. A consultancy company submitting the application or a contractor who will be carrying out the works.)

4. Duration of project

Details of the proposed commencement and completion dates of the works.

A licence is normally valid for 1 calendar year or the duration of the works (whichever is longer) but not normally exceeding 3 years. After this period, it will be necessary for licence holders to re-apply for a further licence to continue any ongoing works. It is the licensee's responsibility to apply for any further licences or an extension prior to the expiry of the initial licence.

5. Description and Cost of the Proposed Project

- (a) This estimate should cover only works taking place below the tidal level of Mean High Water Springs (MHWS) and should take into consideration the cost of materials, labour, fees etc.
- (b) Where the project is expected to take longer than 1 calendar year, this description must detail which elements of work are to be undertaken in the first 12 months, with an outline of the schedule for each further 12 month period of work. (The method of work etc. should be described in the answer to question 7.)
- (c) Select the options which most appropriately describe the type of work proposed. Where the project involves a number of elements, please tick each relevant box.

6. Location of Works

Include a list of the latitude and longitude co-ordinates of the boundary points of the proposed project. In a few cases, (e.g. laying of long pipelines) it may only be practicable to supply co-ordinates for the start and end points.

Latitude and Longitude: For positions read from charts of 1:25,000 scale or smaller, the format should be e.g. **55° 55'.5N 2° 22'.2W**. The decimal point specifies that decimals of minutes are used and the datum is stated explicitly. If appropriate, map co-ordinates from the Irish Grid used by the Ordnance Survey Northern Ireland may be used, to a 6 figure grid reference.

It is important that the correct positions are included with this application, as any errors may result in the application being refused or delayed.

To supplement the information given in section 6, Department of Agriculture, Environment and Rural Affairs (DAERA) Marine and Fisheries Division requires the following to be provided with the completed application form:

- A suitably scaled extract from an Ordnance Survey Map (1:2,500 scale but not more than 1:10,000) or Admiralty Chart which should be marked to indicate
 - The full extent of the works in relation to the surrounding area;
 - Latitude and longitude (or 6 figure IGR) co-ordinates defining the area of operation;
 - The level of Mean High Water Springs (MHWS)
 - Any adjacent Special Area of Conservation (SAC), Area of Special Scientific Interest (ASSI), Special Protection Area (SPA)/RAMSAR or similar conservation area boundary.

DAERA Marine and Fisheries Division will require copies of all documents to be provided for dissemination to others as part of the consultation process. Normally **one** copy of the maps/drawings will be required, if there are ancillary copies required, DAERA Marine and Fisheries Division will advise the applicant accordingly. If they are subject to copyright, **it is the responsibility of the applicant to obtain necessary approvals to reproduce the documents and to submit suitably annotated copies with the application.** Alternatively maps/drawings can be sent electronically by email.

- **Sewer outfalls, discharge pipes for storm overflow and industrial waste etc.** The size and description of the pipe should be shown on the longitudinal sections and also details of any supports, foundations, methods of jointing and details of any tidal flaps.
- **Bridges over tidal waters:** an elevation with longitudinal and cross-sections of the bridge to a suitable scale should show the dimensions of the spans and width of piers, etc. above and below MHWS and the maximum and minimum heights of the undersides of the superstructures above MHWS. The headroom above MHWS and the width of span of the nearest bridges, if any, above and below the site should be stated.

- **Tunnels under tidal waters:** the longitudinal section of the tunnel should show the distances between the bed of the river or estuary and the top of the tunnel. Cross-sections should show the internal and external dimensions of the tunnel and particulars of construction. When a proposed future dredging level is known this must also be shown on all sections.
- **Overhead cables:** catenaries must be supplied in addition to the site plan showing the minimum clearance of the cable at MHWS and the electrical clearance allowed.
- **Marine Aquaculture:** proposals for fish farming and shellfish growing are subject to different procedures (refer to The Marine Licensing (Exempted Activities) Order (Northern Ireland) 2011).

The applicant should note that if the drawings/plans are subject to copyright, **it is the responsibility of the applicant to obtain the necessary approvals to reproduce the documents and to submit suitably annotated copies with the application.**

7. Method Statement

Please provide a full method statement, including details of any temporary structures that may be required below MHWS during the works, and the ultimate fate of the structure and material used in its construction. Details of these structures will be included in any licence that may be issued.

Proposed measures to ensure the marine environment is adequately safeguarded during the work should also be described (e.g. the method to be adopted to ensure that the loss of fine grained material is minimised during construction), as should those taken to minimise any interference with other uses of the sea or foreshore.

8. Permanent Deposits

- (a) Tick the appropriate box (es) to indicate all materials to be deposited below MHWS. If you propose using types of materials for which a specific box is not provided, please describe the nature of such material in the box marked "other".
- (b) If any of the materials to be placed below MHWS are to be brought to the site by sea, give details of the material, e.g. clean rock, and average particle size. Also indicate the vessels to be used, a chart showing the proposed vessel route to the site of the works and details of any trans-shipment areas i.e. where material may be off-loaded to smaller vessels or barges for transport inshore to the site of the works.
- (c) Where the proposed works involve beach replenishment or land reclamation, additional information is required about the material to be deposited and method of delivery. The description of material must include details of its chemical quality. Where the material has not been chemically analysed, DAERA Marine

and Fisheries Division may request representative samples for analysis or require the applicant to arrange for analyses to be undertaken before the licence can be determined.

9. Temporary Deposits

If temporary deposits are required, please provide details as with the permanent deposits above. The temporary deposit location details (Latitude/Longitude) should be added to section 6 of the form, and the period of time the site will be used must be provided. If issuing a licence, DAERA Marine and Fisheries Division will include on the document details of any area that has been approved as a temporary deposit site.

10. Dredging

Indicate whether you are proposing to dredge as part of the works. A separate section of the Marine Licence may be required. The granting of the construction section of the Marine Licence does not imply that the dredging section of the Marine Licence will also be granted, as different assessment criteria are used to determine each type of application.

11. Disposal of material at sea

Indicate whether you are proposing to dispose of any excess material arising from the construction work at sea. A separate section of the Marine Licence may be required. The granting of the construction section of the Marine Licence does not imply that the sea disposal section of the Marine Licence will also be granted, as different assessment criteria are used to determine each type of application.

12. Planning

If the application is subject to planning permission, please give relevant details, including planning reference number, if planning has been approved/rejected and attached a copy of the environmental statement if appropriate.

13. Statutory Consenting Powers

Please describe what (if any) statutory responsibilities you (or your client) have to consent any aspect of the project.

14. Consultation

- (a) Have the public been invited to comment on these proposals? if so to whom and what was the closing date

(b) Have any consultation meetings been held with the public/other bodies? If so where and when?

15. Consultation with Conservation Bodies

Consenting authorities have a duty to ensure that any works will not have a significant adverse environmental impact, particularly upon designated conservation areas (e.g. ASSIs/SAC, SPA/RAMSAR sites etc) listed under The Conservation (Natural Habitats, etc.) (Amendment) Regulations (Northern Ireland) 2007. If the applicant (particularly if they have statutory powers for consenting aspects of these works) has already been in consultation with the appropriate nature conservation body – NIEA, Natural Environment Division, please supply any response that they may have given.

Any application for beach replenishment works should be cross checked as to whether the proposed site is a designated bathing water site and if so, ideally all physical works should be done outwith the Bathing Water Season (1st June to 15th September). Further guidance on the Bathing waters Directive (76/160/EEC) can be obtained from <http://www.ni-environment.gov.uk/water-home/quality/bathingqualityni.htm>

In addition, guidance can be obtained from www.foodstandards.gov.uk/ with regards to the Shellfish Waters Directive (2006/113/EC) which has parameters set to protect the water quality in which edible shellfish are grown.

16. Designated Conservation Areas

Indicate whether the proposed works are located within or close to the boundaries of a conservation area such as an ASSI, SAC, SPA or Ramsar Site.

17. Environmental Assessment

Please indicate whether any environmental assessments have been carried out in respect of the proposed works, either under your own powers or as required by another authority. If such an assessment has been undertaken, please indicate if a copy has been provided with your application. If the statement/assessment has been completed but is not available, please provide an explanation in the space provided.

Additionally please also give details if and where a copy has been/ is being made available for public inspection.

Please ensure that you have:

- Completed **all** appropriate sections of the application form
- Signed and dated the declaration
- Provided the relevant documentation, charts and continuation sheets and
- Enclosed the correct payment (refer to fees addendum) or paid by means of BACS (if appropriate)

**Otherwise your application will be delayed or returned to you
Marine and Coastal Access Act 2009 (Part 4 Marine Licensing)**

**Application for Marine Construction Works/Land Reclamation/Beach
Replenishment in the Territorial Sea and UK Controlled Waters Adjacent to
Northern Ireland**

(Construction schemes including coast defences, beneficial uses of dredged materials,
jetties, land reclamation, outfall pipes etc.)

**It is the responsibility of the applicant to obtain any other consents or
authorisations that may be required**

**Under Part 4 (Chapter 5) of the Marine and Coastal Access Act 2009, information
contained within or provided in support of this application will be placed on the
public register unless DAERA Marine and Fisheries Division (as the licensing
authority) approves the applicant's reasons for withholding all or part thereof.**

Public Register

Is there any information contained within or provided in support of this application that
you consider should not be included on the Public Register on the grounds that its
disclosure:

a) would be contrary to the interests of national security YES NO

b) would prejudice to an unreasonable degree your or some
other person's commercial interests or those of a third party? YES NO

If **YES**, to either (a) or (b), please provide full justification as to why all or part of the
information you have provided should be withheld.

1. Project Title

Please give a brief identifiable description, including the location of the works.

Blackhead Coastal Path runs northward from the public car park located at Old Castle Road, Whitehead to the base of the cliffs at Blackhead. The path provides a right of way giving the only means of access to two residential properties approximately 1.2km from the car park. This shared vehicular access route is used by residents and service vehicles such as home heating oil tankers and postal vans. The path also provides a recreational amenity site to the public which is very popular with walkers.

A 200m section of the path is failing due to excessive loading from the landward embankment which is subject to ongoing landslips. As a result, the path is currently closed to vehicular access. It is proposed to install approximately 200m of new rock armour causeway on the foreshore along the front of the existing sheet piled section of promenade wall. The causeway will provide slope stability and maintain vehicular access for the local residents.

An additional section of 115m of rock armour is proposed along the existing concrete revetment to tie in to the existing rock armour slope at the car park.

2. Applicant Details

Title Initials Surname

Address:

Mid and East Antrim Borough Council
1-29 Bridge Street
Ballymena
BT43 5EJ

Name of contact:
(if different from above)

Telephone number:
(inc. code)

0300 124 5000

Email address:

enquires@midandeastantrim.gov.uk

3. Agent Details (if appropriate)

Title	Mr	Initials	K	Surname	McCusker
Trading Title (if different from above)	AECOM Ltd				
Business Address:	9th Floor, The Clarence West Building, 2 Clarence St West, Belfast, BT2 7GP				
Name of contact: (if different from above)					
Position within company (if appropriate)	Associate Director				
Telephone number: (inc. code)	02890 607200				
Email address:	Karol.McCusker@aecom.com				
Company Registration No.	1846493				

4. Duration of Project

Expected Start Date	Jan 2019	Expected Completion Date	Oct 2019
---------------------	----------	--------------------------	----------

5. Description and Cost of the Proposed Project

(a) Estimated gross cost of the works proposed seawards of the tidal limit of the High Water Mean Spring Tide Mark

£287,400

(b) Give a detailed description of the proposed schedule of work

The following provides a summary of the proposed schedule of works, based on the information available at the time of this application. The proposed works for Black-head Coastal Path encompasses the following:

- Install 200m of new rock armour causeway
- Install approximately 115m of additional rock armour revetment along the existing concrete revetment to tie in to the existing rock armour slope at the car park
- Remove approximately 190m of existing concrete promenade surface to a depth of 1m.
- Install 200m of new 7m wide concrete path surface.
- Remove 200m of existing kee klamp steel post and rail fence.
- Install 200m of new galvanised steel, corrosion protected, kee klamp post and rail fence.
- Install approx. 76m length of new stone gabion baskets to act as a retaining wall.
- Install 122m of new 150mm diameter perforated PVC pipe filter drain and type 3 granular surround on the upland side of stone gabion wall, including 6No. inspection chambers connecting into a new manhole.

Drawing BHCP-ACM-00-XX-DR-CE-7003 illustrates the proposed works and is provided in the attached drawings.

If necessary please continue on a separate sheet and tick this box

Types of Work Proposed

Coastal/Flood defences:	beach replenishment shoreline reinforcement flood defence sea defence	X
Slipways:	slipway causeway launching ramp	
Miscellaneous:	habitat creation/replacement aquaculture (unless exempted) sea wall berms/wave screens artificial reef sea-lock	
Harbour works:	dock wall/quay/wharf	
Navigation works:	lock gates moorings (unless exempted) buoy/navigation mark (unless exempted) training wall/breakwater	
Land reclamation:	bunded/piled area dock infill	
Intakes/outfall pipes:	intake/outfall	
Cables:	cable/subsea cable	
Pipeline maintenance:	pipe/pipeline maintenance	
Piers etc.:	bridge supports/bridge foundation pier jetty	
Bank stabilisation:		X
Scour protection:	gabion mattressing	
Barrages & island etc.	tidal barrier	

barrage
sculpture, statues, fountains etc.
ground investigation works
impoundment
groynes

Sediment manipulation

6. Location of Works

This should include either 6 figure Irish Grid Reference (IGR) or Latitude and Longitude co-ordinates (WGS84 to 1 decimal minute) defining the extent of the project.

IGR (347939,392276) (347916,392308) (347940, 392416) (347994, 392531)
(348033, 392582) (347997, 392491) (347963, 392425)
A Location Plan drawing (BHCP-ACM-00-XX-DR-CE-7015) is provided in the attached drawings showing the extents of the works in relation to the surrounding area.

If necessary, please continue on a separate sheet and tick this box

7. Method Statement

General Description of the Works:

The works will involve the placement of rock armour along a 315m section of beach at Blackhead Coastal Path where severe damage to the existing coastal protection system of steel sheet piles has resulted in the failure of the existing system and pathway. It is proposed to construct a revetment using rock armour to replace the existing sheet piles and allow for the construction of a new pathway/promenade to replace the existing failing one.

Please refer to attached document for additional details.

If necessary, please continue on a separate sheet and tick this box

8. Permanent Deposits

(a) quantity of permanent materials to be deposited below HMWS tidemark:

Timber (m² or tonnes)

Iron/Steel (tonnes)

Plastic/Synthetic (m²)... Geotextile 7000m².....

Silt (m³)

Sand (m³)

Concrete (m³)

Concrete bags/mattresses
(Confirm number, dimensions
& total volume m³)

Stone/Rock/Gravel
(size range and volume m³) 6765 m³

If 'other' please describe below

If necessary, please continue on a separate sheet and tick this box

(b) for work involving salt marsh feeding, beach replenishment or land reclamation please provide the following information relating to the material to be deposited:

Quantity (tonnes)

Nature of Material
(e.g. sand, silt, gravel etc.)

Source:
(if sea dredged please state
location of origin)

Particle Size

Has the material been chemically analysed? Yes No

If Yes, please include the analysis data with your application.

9. Temporary Deposits

Will there be a need to make any temporary deposits of material below HMWS tidemark during the works

Yes No

(a) quantity of temporary materials to be deposited below HMWS tidemark:

- Timber (m² or tonnes)
- Iron/Steel (tonnes)
- Plastic/Synthetic (m²)
- Silt (m³)
- Sand (m³)
- Concrete (m³)
- Concrete bags/mattresses
(Confirm number, dimensions
& total volume m³)
- Stone/Rock/Gravel
(size range and volume m³)

If 'other' please describe below

The works access causeway from the car park to the foreshore level will be incorporated into the final rock armour section along the front of the existing concrete revetment.

If necessary, please continue on a separate sheet and tick this box

10. Dredging

Do you intend to apply for a licence to dredge as part of the works?

Yes No

If Yes, please indicate the location
of the dredging and nature of material

11. Disposal of Material at Sea

Do you intend to apply for a licence to dispose at sea material dredged as part of the works?

Yes No

If Yes, please indicate:
Nature and quantity of material
(sand, gravel, silt, clay, rock etc.)

12. Planning

Is this project subject to a planning application?

Yes No

If Yes, attach a copy of environmental statement (if appropriate) and indicate what stage the application for planning permission is at (i.e. approved, awaiting notification, rejected)

A Planning Application was submitted 08/08/2018 (Ref LA02/2018/0787/F)
.....

13. Statutory Consenting Powers

Do you, or (if appropriate) your client, have statutory powers to consent any aspect of this project?

Yes No

If Yes, please give details

14. Consultation

(a) Have the public been invited to submit comments? **YES** **NO**
If **YES**, how and where?

(b) Have any consultation meetings been held? **YES** **NO**
(with the public or other bodies)

Preliminary meetings and site visits have been held with Michael Cubitt (DAERA Marine Strategy & Licensing Branch).
Various meetings and presentations have been held with local councillors from Mid and East Antrim Borough Council.
Informal discussions with the local residents who require residential access along the path have also been held.

If necessary please continue on a separate sheet and tick this box

15. Consultation with Conservation Bodies

Please provide details of any consultation that has taken place with NIEA Natural Environment Division and, if appropriate, include copies of any correspondence with your application.

Preliminary meeting outlining the proposed works was held at NIEA offices on 03/07/2018. In attendance were Michael Dempster (DAERA Earth Scientist) and Neil McCullough (Ecology). Both parties confirmed that there were no significant issues with the proposed Rock Armour works at this stage.

If necessary please continue on a separate sheet and tick this box

16. Designated Conservation Areas

Are any parts of the proposed work located within the boundaries of a designated conservation area? **YES** **NO**

If **No**, please indicate approximate distance of the disposal operation from the nearest designated conservation area.

17. Environmental Assessment

Has an environmental assessment been undertaken to support any application in respect of the works, your own statutory powers (if applicable) or any other reason?

YES **NO**

If **YES**, is a copy of the assessment included with this application?

YES **NO**

If the assessment has been undertaken but has not been included with the application, please provide an explanation below.

Is the environmental assessment available for public inspection?

YES **NO**

If YES at what locations:

Declaration

I declare that the information given in this form and related papers is to the best of my knowledge and belief true.

WARNING
It is an offence under the Act under which this application is made to fail to disclose information or to provide false or misleading information.

Signature of applicant:
(or agent acting on behalf of applicant)

Date:

Name (Block Letters):

Position within company:
(if applicable)

PLEASE CHECK CAREFULLY THE INFORMATION YOU HAVE GIVEN AND THAT ALL ENCLOSURES (INCLUDING COPIES) HAVE BEEN INCLUDED

Application Checklist

- **Completed application form**
- **Project drawings**
- **Method statement**
- **Maps/charts**
- **Additional environmental information e.g. photographs, environmental impact assessment etc.**
- **Payment**

7. Method Statement

General Description of the Works

The works will involve the placement of rock armour along a 315m section of beach at Blackhead Coastal Path where severe damage to the existing coastal protection system of steel sheet piles has resulted in the failure of the existing system and pathway. It is proposed to construct a revetment using rock armour to replace the existing sheet piles and allow for the construction of a new pathway/promenade to replace the existing failing one.

Rock Revetment Works

The new rock revetment shall be constructed in the following order:

1. The area where the rock revetment is to be installed shall have all large stones and debris removed
2. A trench shall be excavated along the line of the proposed toe stone. This will be completed in short sections at low tide. The toe stone shall be installed in dry mix concrete over a geotextile layer.
3. The geotextile shall be laid landward to the existing steel sheet pile revetment. The geotextile layer will be covered in a conforming layer of stone.
4. Rock armour will be placed on top of the conforming layer, starting at the toe stone and working back landward. The secondary layer of rock armour will be placed first, followed by primary stone layer. Placing of rock armour is to commence at the lower end i.e. seaward side and proceed inwards and upwards towards the existing sheet piles and promenade wall.
5. When working on the beach machine operatives will take cognisance of ground conditions. All works shall be carried out at low tide if possible.
6. On completion of the rock armour installation the existing/failing promenade/path shall be broken out and removed.
7. Construction of the new promenade/path shall be integrated into the new rock armour revetment.
8. On completion of the works all temporary structures, plant and machinery shall be removed and the beach shall be reinstated to its previous condition and level.

Construction Traffic

The primary construction equipment to be used on site will comprise an excavator (20-30Ton), JCB, 8Ton Dumper and a 20Ton lorry to deliver the rock armour. Hydraulic excavators with grab attachment will be used for individual placement of rock armour. Several potential pollutants will be utilised at the site, including diesel, engine/hydraulic oils, etc. Contractor will ensure they are using bio-diesel in machinery. Mobile equipment should have warning reversing sirens and cameras. Emergency repair tools and/or towing equipment is to be made available in case of broken down machines before they are submerged by the tide.

Stockpiling of Material on Site

There will be a minimum amount of stock piling of materials on site (stones etc). Primary armour stone to be placed seaward of the secondary armour stone and underlayer stone, this will allow protection for the smaller stone during stormy or flooding conditions.

DRAWINGS

DRAWING REFERENCE	DRAWING TITLE / DESCRIPTION
B CP-AC -00- -DR-C - 015	CTIO A OCATIO P A
B CP-AC -00- -DR-C - 002	I TI G P A A D CTIO
B CP-AC -00- -DR-C - 00	PROPO D P A A D CTIO

Last saved by: KERRA2(2018-09-04) Last Plotted: 2018-09-04
 Filename: \\BE-MAN-001\SCOTT\WILLSON\CO\UK\CIVIL\DRAWINGS\BLACKHEAD COASTAL PATH\07 - CIVIL ENG\DRAWINGS\01-WIP\CE\01_01-DRAWINGS\PLANNING\DRAWINGS\7015 - MARINE LICENCE LOCATION PLAN.DWG
 Project Management Initials: Designer: AK Checked: JT Approved: KMcC



SITE LOCATION PLAN
SCALE @ A1 1:1,250

SITE LOCATION PLAN
SCALE @ A1 1:10,000



AECOM
9th Floor, The Clarence West Building
2 Clarence Street West
+44 (0)28 9060 7200
www.aecom.com

- SITE BOUNDARY
- NORTH CHANNEL SAC BOUNDARY
- + IRISH GRID COORDINATE
- LWMMT
- HWMMT

IR	DATE	DESCRIPTION
0	08/08/18	FOR SUBMISSION

60538723

BLACKHEAD COASTAL PATH
MARINE LICENCE APPLICATION
SECTION A LOCATION PLAN

BHCP-ACM-00-XX-DR-CE-7015

- AREA OF SLIP
- METAL RAILINGS
- VEGETATED AND GRASSY SLOPE
- SHEET PILES
- SLOPING CONCRETE AND STONE FACADE
- PATH EDGES OF SECTION A UPPER
- PROMENADE EDGES OF SECTION A LOWER
- 2.5m CONTOUR LINE

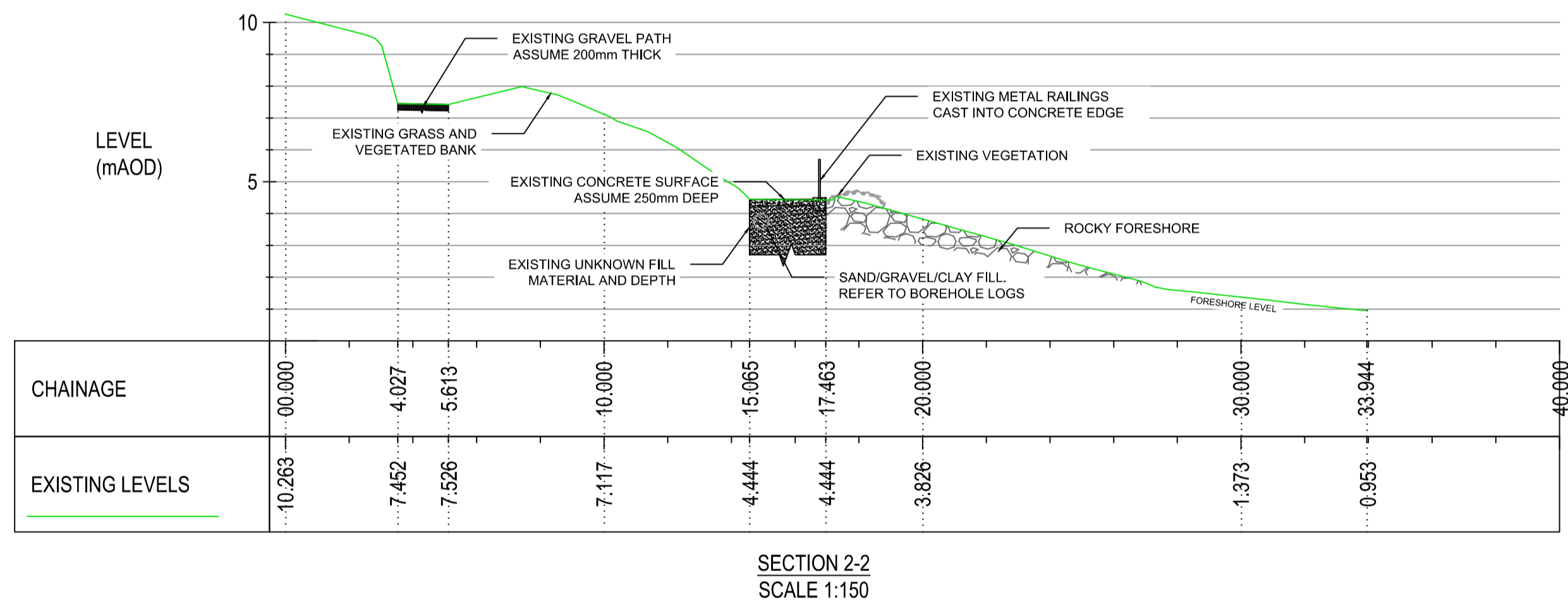
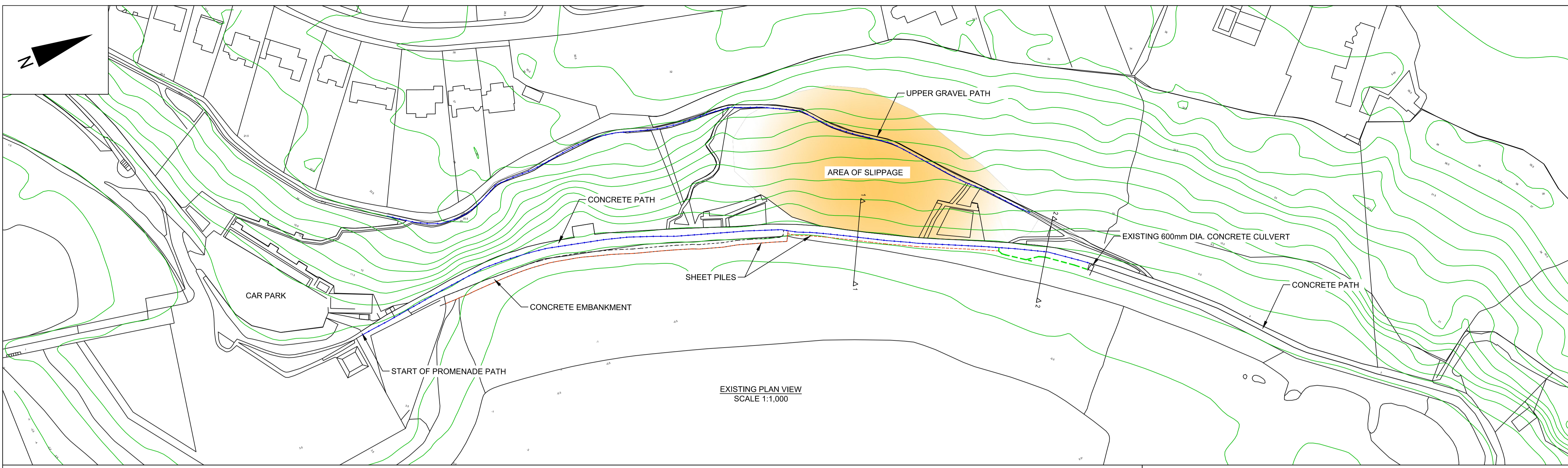

NOTES:

1. THIS DRAWING IS TO BE READ IN CONJUNCTION WITH ALL OTHER RELEVANT DOCUMENTATION.
2. DO NOT SCALE FROM THIS DRAWING. USE ONLY PRINTED DIMENSIONS.
3. ALL DIMENSIONS IN MILLIMETERS, ALL CHAINAGES, LEVELS AND COORDINATES ARE IN METERS UNLESS DEFINED OTHERWISE.
4. THIS DRAWING IS TO BE READ IN CONJUNCTION WITH THE PROJECT HEALTH & SAFETY FILE FOR ANY IDENTIFIED POTENTIAL RISKS.
5. SERVICE DETAILS AND EXTENTS ARE INDICATIVE AND FOR INFORMATION ONLY.
6. CONTRACTOR TO REQUEST NEW SERVICE DRAWINGS FROM THE RELATIVE SERVICE PROVIDERS PRIOR TO ANY SITE WORKS.
7. CONTRACTOR TO ENSURE ABANDONED SERVICE RECORDS ARE CORRECT PRIOR TO ANY EXCAVATION WORKS.
8. IT IS ENVISAGED THAT SERVICES WITHIN THE EXISTING PROMENADE STRUCTURE WILL NOT BE DISTURBED.
9. IF REQUIRED, CONTRACTOR IS TO ENSURE EXCAVATION AND REMOVAL OF HAZARDOUS MATERIALS IN ACCORDANCE WITH THE SPECIFICATION AND WASTE DISPOSAL REQUIREMENTS.

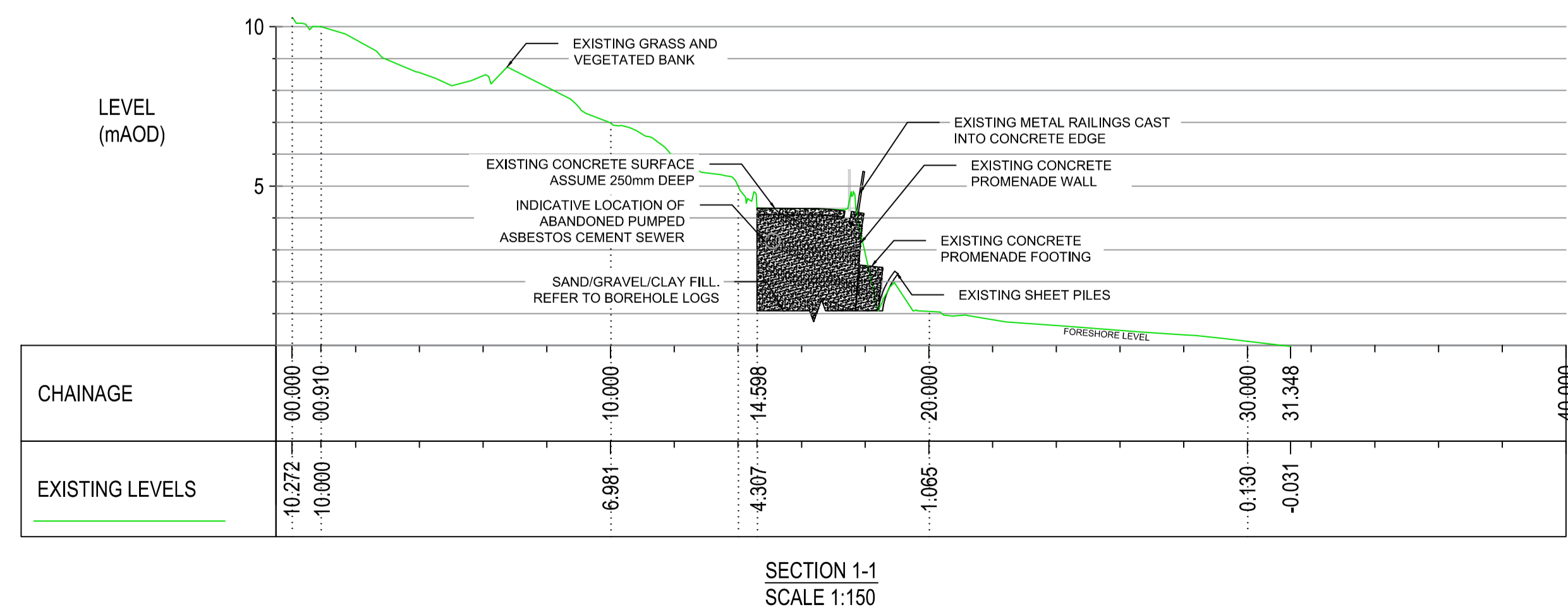

ISSUE/REVISION

I/R	DATE	DESCRIPTION
0	26/07/18	FOR SUBMISSION

PROJECT NUMBER

60538723





SHEET TITLE

BLACKHEAD COSTAL PATH
 SECTION A
 EXISTING PLAN AND SECTIONS

SHEET NUMBER

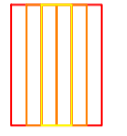
BHCP-ACM-00-XX-DR-CE-7002

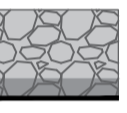
LEGEND

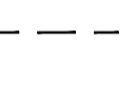
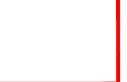
	STONE FILLED GABIONS
	NEW REINFORCED CONCRETE SURFACE
	ROCK ARMOUR AND TOE STONE EXTENT
	LINE OF NEW DRAINAGE
	NEW KEE KLAMP HAND RAILS
	NEW 700mm DIA. CONCRETE OUTLET PIPE & CULVERT
	INDICATIVE LOCATION OF TEMPORARY SITE COMPOUND

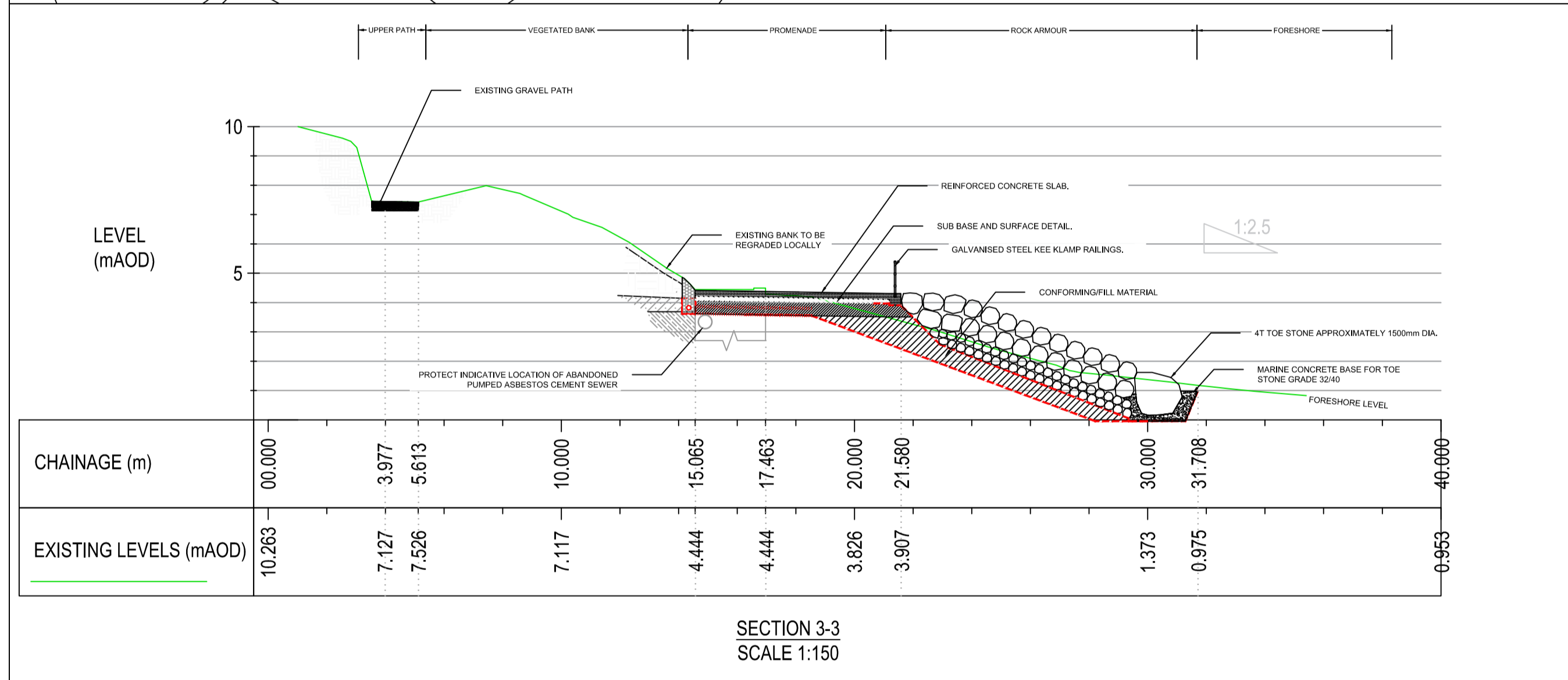
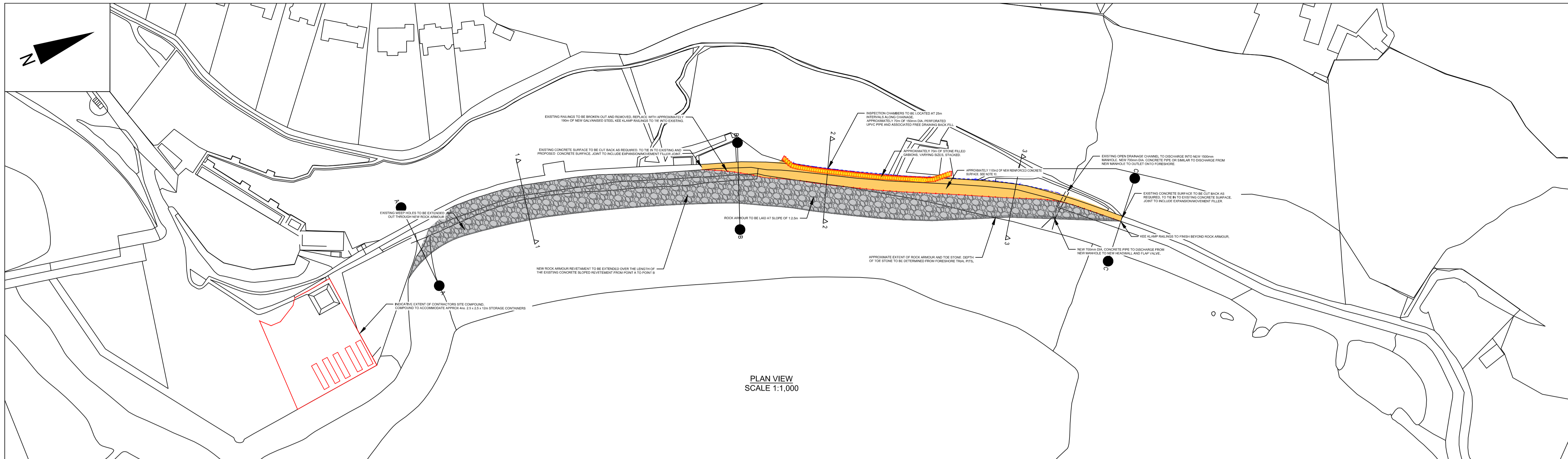

- NOTES:**
1. THIS DRAWING IS TO BE READ IN CONJUNCTION WITH ALL OTHER RELEVANT DOCUMENTATION.
 2. DO NOT SCALE FROM THIS DRAWING, USE ONLY PRINTED DIMENSIONS.
 3. ALL DIMENSIONS IN MILLIMETERS, ALL CHAINAGES, LEVELS AND COORDINATES ARE IN METERS UNLESS DEFINED OTHERWISE.
 4. THIS DRAWING IS TO BE READ IN CONJUNCTION WITH THE PROJECT HEALTH & SAFETY FILE FOR ANY IDENTIFIED POTENTIAL RISKS.
 5. SERVICE DETAILS AND EXTENTS ARE INDICATIVE AND FOR INFORMATION ONLY.
 6. CONTRACTOR TO REQUEST NEW SERVICE DRAWINGS FROM THE RELATIVE SERVICE PROVIDERS PRIOR TO ANY SITE WORKS.
 7. CONTRACTOR TO ENSURE ABANDONED SERVICE RECORDS ARE CORRECT PRIOR TO ANY EXCAVATION WORKS.
 8. IT IS ENVISAGED THAT SERVICES WITHIN THE EXISTING PROMENADE STRUCTURE WILL NOT BE DISTURBED.
 9. IF REQUIRED, CONTRACTOR IS TO ENSURE EXCAVATION AND REMOVAL OF HAZARDOUS MATERIALS IS IN ACCORDANCE WITH THE SPECIFICATION AND WASTE DISPOSAL REQUIREMENTS.
 10. CONCRETE SURFACE SLABS TO USE A393 REINFORCING MESH MANUFACTURED TO BS4483/2005. CONCRETE TO BE 32/40 MIX.
 11. STONE GABIONS TO BE PVC COATED GALVANISED MESH, FILLED WITH STONE CONFORMING TO CLASS 6G PF THE SPECIFICATION FOR HIGHWAY WORKS.

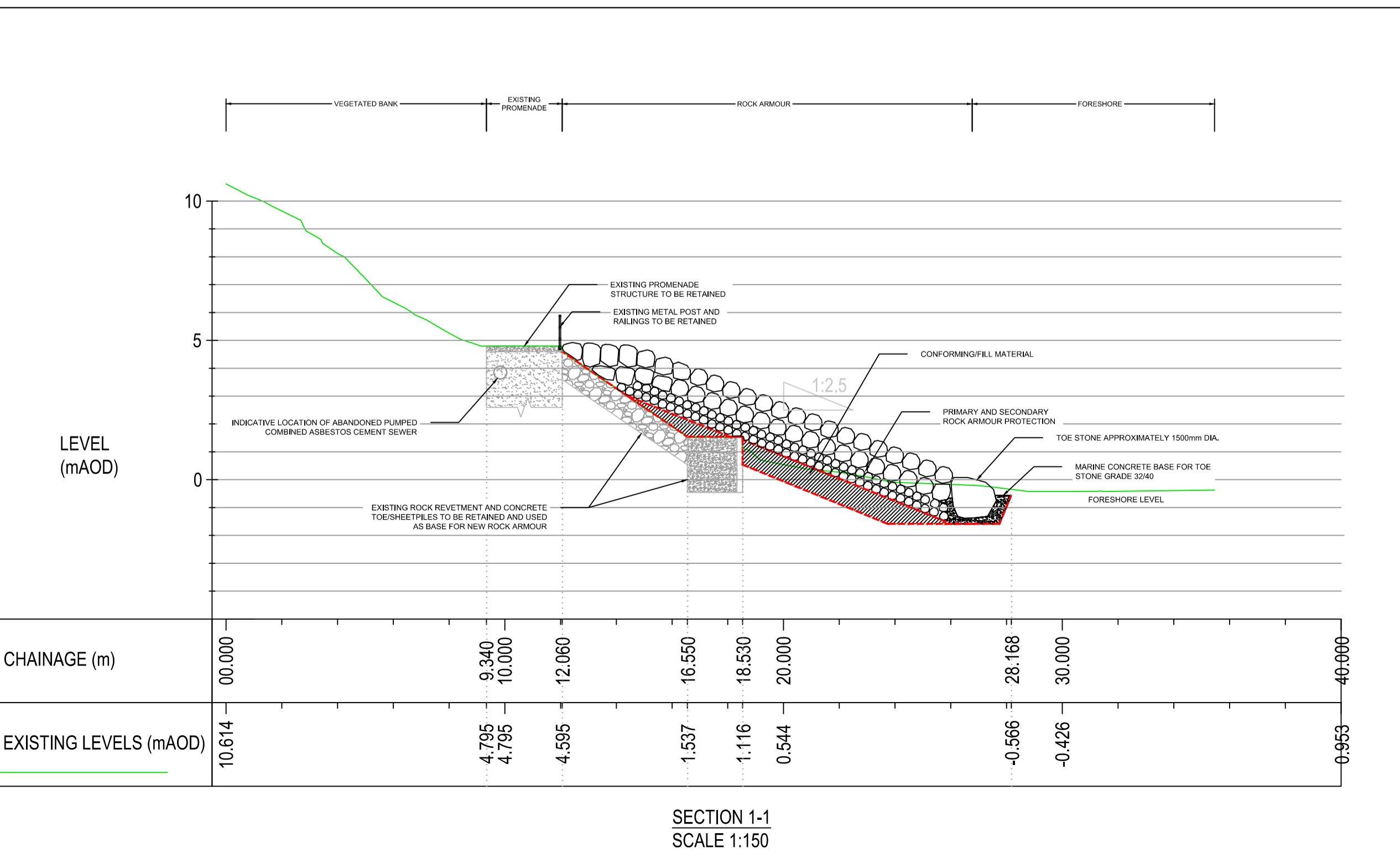
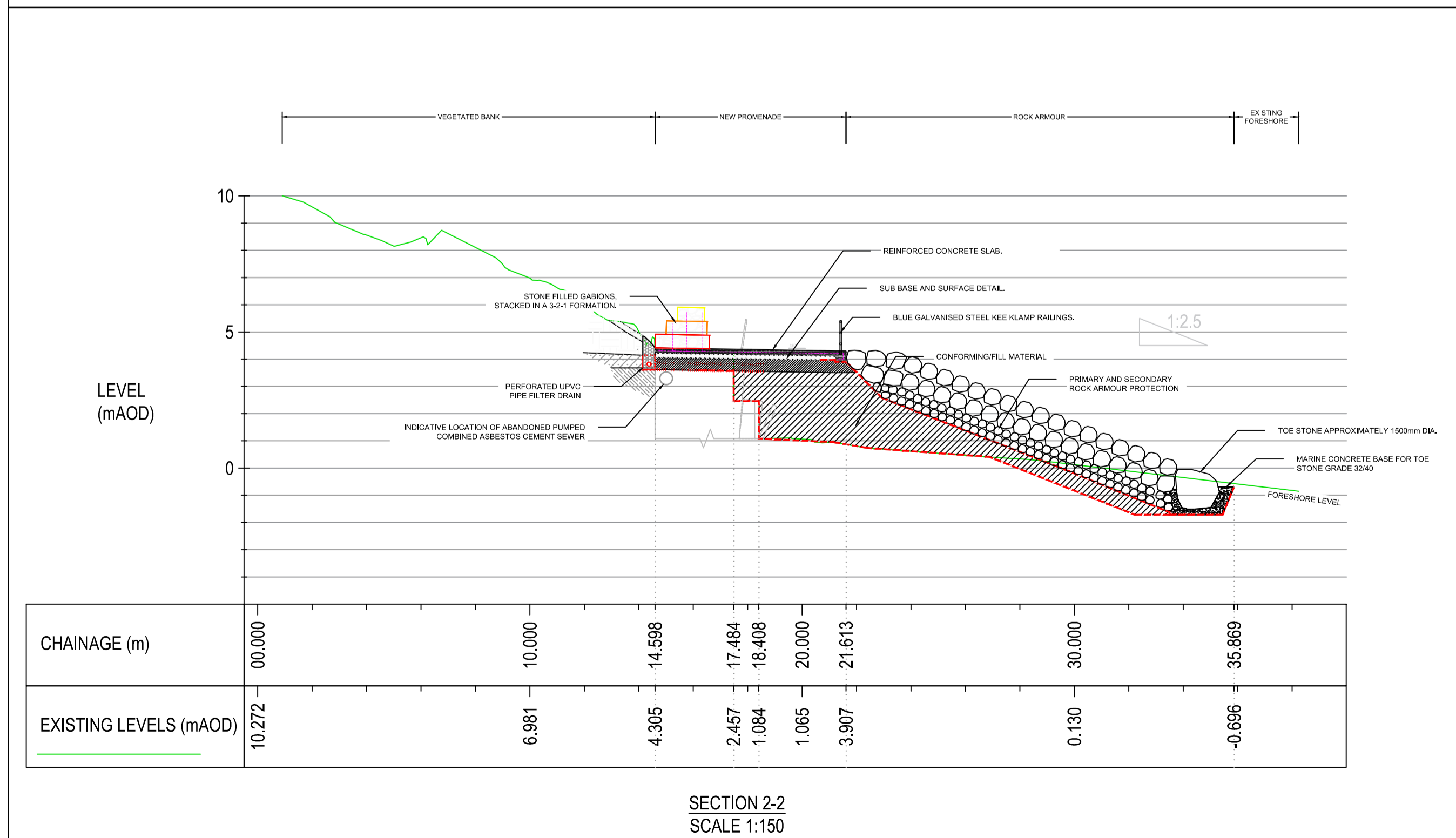

ISSUE/REVISION

I/R	DATE	DESCRIPTION
0	26/07/18	FOR SUBMISSION

PROJECT NUMBER
60538723

SHEET TITLE
BLACKHEAD COSTAL PATH
SECTION A
PROPOSED PLAN AND SECTIONS

SHEET NUMBER
BHCP-ACM-00-XX-DR-CE-7003

Approved: KMcC
 Checked: JT
 Designer: AK
 Project Management Initials:
 Last saved by: KERRA2(2018-07-31) Last Plotted: 2018-07-31
 Filename: G:\DOCUMENTS\BLACKHEAD COASTAL PATH\07 - CIVIL ENGINE\DRAWINGS\01-WIP\CE\01_01-DRAWINGS\PLANNING\DRAWINGS\7003 - PROPOSED PLAN AND SECTIONS.DWG